

- 1
- 2
- 3
- 4
- 5
- 6
- 7
- 8
- 9
- 10
- 11
- 12
- 13
- 14
- 15
- 16
- 17
- 18

**MATERIAL**

Glass-fibre reinforced polypropylene based (PP) technopolymer, black colour, matte finish.

**ROTATING PIN**

AISI 303 stainless steel.

**STANDARD EXECUTION**

Pass-through holes for countersunk head screws.

**ROTATION ANGLE (APPROXIMATE VALUE)**

Max 200° (-20° and +180° being 0° the condition where the interconnected surfaces are on the same plane).

Do not exceed the rotation angle limit so as not to prejudice the hinge mechanical performance.

To choose the convenient type and the right number of hinges for your application, see the Guidelines (see page 952).

**FEATURES AND APPLICATIONS**

Polypropylene hinges are particularly suitable for those sectors where they can be in contact with chemical agents and/or for frequent washing with acidic or basic detergent solutions, such as in the chemical, process, pharmaceutical, food, textile and paper industry.



ELESA Original design

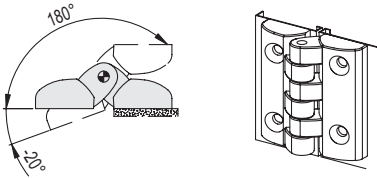

Resistance tests	Axial Stress		Radial Stress		90° Angled Stress	
	Maximum working load Ea [N]	Load at breakage Ra [N]	Maximum working load Er [N]	Load at breakage Rr [N]	Maximum working load E90 [N]	Load at breakage R90 [N]
CFTX.40-PP	200	1100	200	1200	200	600
CFTX.49-PP	300	1700	300	1400	300	900
CFTX.65-PP	500	3000	500	2100	500	1400

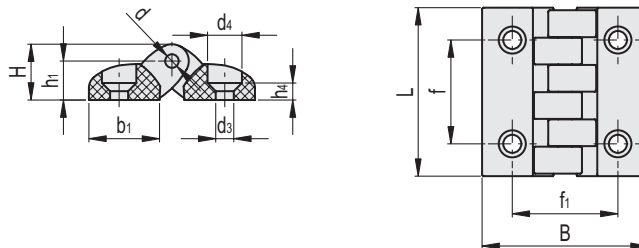

**Conversion Table**  
1 mm = 0.039 inch

L	
mm	inch
39.5	1.56
49.5	1.95
65	2.56

**METRIC**

Code	Description	L	B	f±0.25	f1±0.25	H	h1	h4	b1	d	d3	d4	C# [Nm]	⚖
427311	CFTX.40 PP-SH-4	39.5	38.5	25	25	13	9	4.5	16.5	3	4.5	8.5	2	10
427331	CFTX.49 PP-SH-5	49.5	49	30.5	31	16.5	11.5	5	21	4	5.5	10.5	2	20
427351	CFTX.65 PP-SH-6	65	64	40	40	21.5	15	9	27.5	5	6.5	12.5	2	57

Hinges and accessories